

17

Cut back existing Concrete Riprap 2', leaving at least 6" of Wire Mesh exposed to lap with new Mesh. Extend Riprap as shown, using details given on Dwg. 14725A

Note: Side Slopes Due to Raising Grade Shall Intersect the Existing Embankment at A Location to be Determined by the Engineer.

PLAN	SECTION	PLAN	SECTION	FED. ROAD NO.	STATE	FED. AID PROJ. NO.	SHEET NO.	TOTAL SHEETS
				6	ARK.	1-55-1(80)13	31	71
JOB NO.						11990		
DRAWING NO.						3137R LAYOUT	23222	

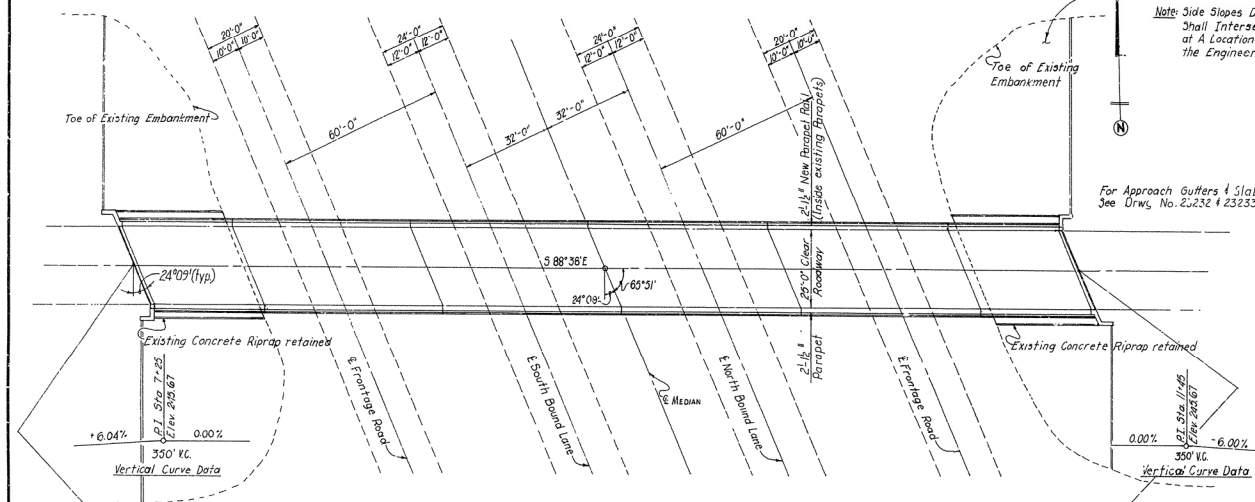

PLAN

Total Length of Bridge - 342'-6 1/4"

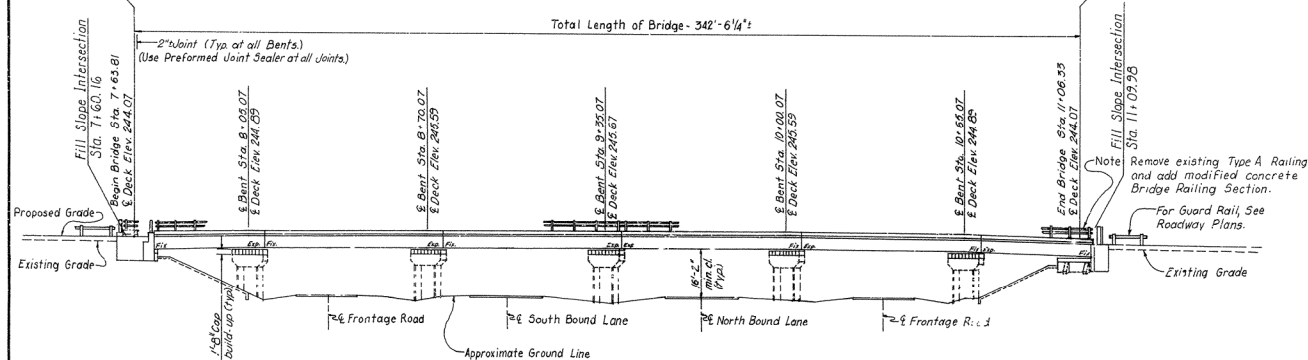

ELEVATION

Note: Stations and Elevations shown are for new Bridge Position.

GENERAL NOTES

- TEMPORARY BENCH MARK: TOP OF DECK WEST END OF BRIDGE, ELEV. 242.40.
- PROPOSED WORK CONSISTS OF RAISING BRIDGE BY CONSTRUCTING CONCRETE PEDESTALS ON ALL BENTS AND REBUILDING BACKWALLS AT END BENTS; REPAIRING BENT CAPS WHERE NECESSARY; REMOVING EXISTING TYPE "A" RAIL AND INSTALLING CONCRETE PARAPET RAILING AGAINST THE EXISTING PARAPET WALLS; INSTALLING PREFORMED JOINT SEALER AT ALL JOINTS; PAINTING EXISTING STRUCTURAL STEEL; APPLYING A SPRAYED FINISH TO NEW AND EXISTING CONCRETE AND EXTENDING THE CONCRETE RIPRAP AS SHOWN ON THE PLANS.
- THE CONTRACTOR SHALL BE RESPONSIBLE FOR MAKING CHECK MEASUREMENTS OF EXISTING BRIDGE AND MAKING NECESSARY ADJUSTMENTS TO THE NEW WORK.
- FOR REQUIREMENTS IN CONDUCTING THE WORK, SEE SPECIAL PROVISION JOB NO. 11990, "REMODELING OF EXISTING BRIDGE STRUCTURES."
- ALL CONCRETE IN NEW WORK TO BE CLASS 5 OR 5043 AND SHALL HAVE A MINIMUM 28 DAY COMPRESSIVE STRENGTH  $f_c = 3500$  PSI. ALL EXPOSED CORNERS TO BE CHAMFERED 3/4" UNLESS OTHERWISE NOTED.
- ALL NEW REINFORCING STEEL SHALL CONFORM TO ASTM A615 OR A617, GRADE 60.
- DESIGN LIVE LOADING: H20
- DESIGN SPECIFICATIONS: FOR NEW WORK, AASHTO STANDARD SPECIFICATIONS FOR HIGHWAY BRIDGES, 1977 WITH CURRENT INTERIM SPECIFICATIONS.
- CONSTRUCTION SPECIFICATIONS: ARKANSAS STATE HIGHWAY COMMISSION STANDARD SPECIFICATIONS FOR HIGHWAY CONSTRUCTION, EDITION OF 1978 AND APPLICABLE SPECIAL PROVISIONS.
- FOR DETAILS OF REMODELING END BENTS, SEE DWG. NO. 2322.
- FOR DETAILS OF REMODELING INT. BENTS, SEE DWG. NO. 23224
- FOR DETAILS OF SPAN MODIFICATIONS, SEE DWG. NOS. 23225 & 23215
- HALF-SIZE DETAIL SHEETS OF THE EXISTING BRIDGE MAY BE OBTAINED FROM THE ARKANSAS HIGHWAY AND TRANSPORTATION DEPARTMENT UPON REQUEST TO THE BRIDGE ENGINEER.
- FOR ROUTING OF TRAFFIC DURING CONSTRUCTION, SEE SPECIAL PROVISION JOB 11990, "MAINTENANCE OF TRAFFIC."

LAYOUT OF  
CLARKDALE INTERCHANGE  
MARION-LAKE DAVID OVERPASS ALTERATIONS  
CRITTENDEN COUNTY  
ROUTE I-55 SEC. II  
ARKANSAS STATE HIGHWAY COMMISSION

LITTLE ROCK, ARK.  
DRAWN BY: D.W. DATE: 7-2-78  
CHECKED BY: C.E.S. DATE: 10-22-79  
DESIGNED BY: DATE: SCALE: 1"=20'  
BRIDGE NO. 3137 R DRAWING NO. 23222

BRIDGE ENGINEER

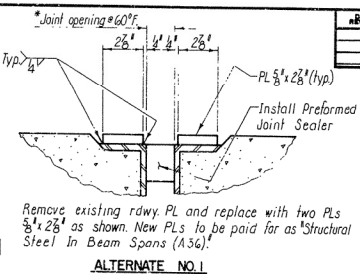
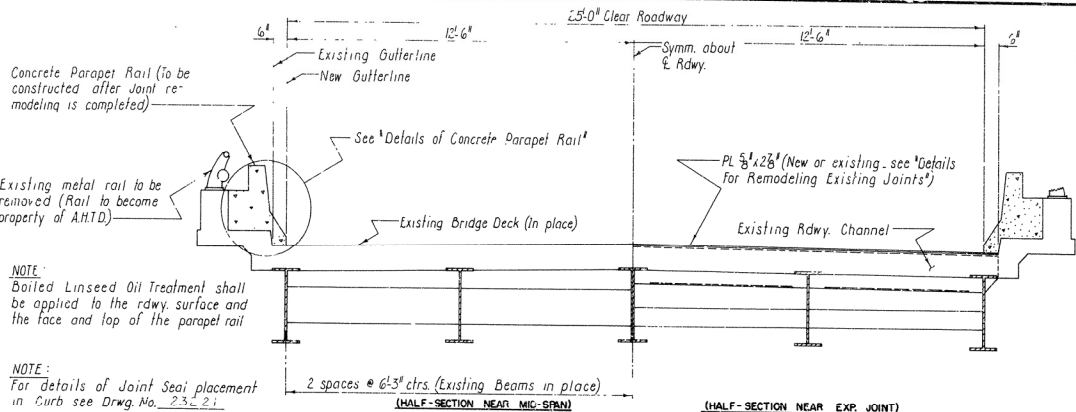

ALTERNATE NO. 1

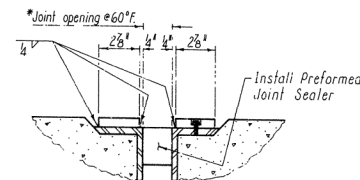

ALTERNATE NO. 2

\*The Joint opening @ 60" F. shall be determined in the field. Do not obtain Preformed Joint Sealer until Joint sizes are determined. For Bid purposes only, the assumed Joint openings are 2', requiring a 3' uncompressed Seal width.

DETAILS FOR REMODELING EXISTING JOINTS

No Scale  
NOTE: Joint details shown are of Int. Bents 2-6. Joints at End Bents 1 & 7 are similar except that only one 3/8 x 26' rdwy. plate is req'd per Joint. For add'l. details of Joints at End Bts. 1 & 7 see Drwg. No. 232-23

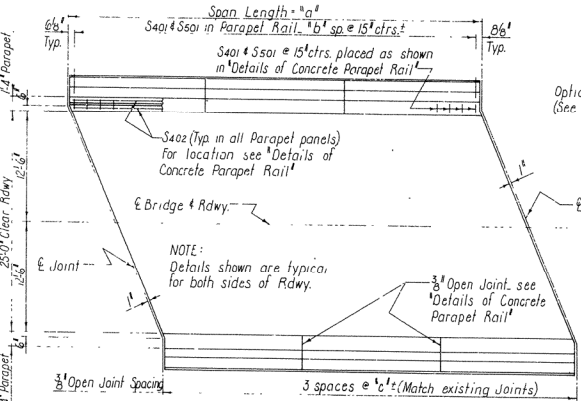

TYPICAL SPAN DETAIL  
No Scale

SPAN LGTH	a	b	c	d
40'-0"	3'	18'-4"	12'-0"	
65'-0"	5'	21'-6"	20'-0"	

BAR LIST EACH SPAN

MARK	NO. REQ'D	LENGTH	PIN DIA.
S401	64	104	2 1/2"
S402	18	18	**
S501	64	104	2 1/2"

\*\* Length of S402 = 12'-11" in 40' Spans  
Length of S402 = 21'-3" in 65' Spans

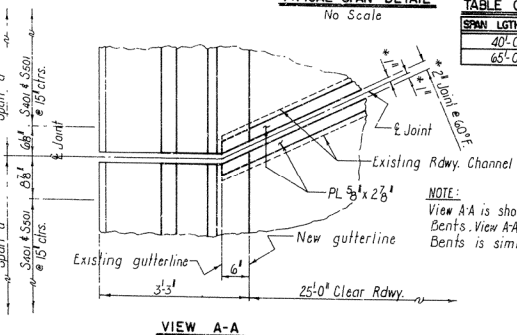

VIEW A-A

DETAILS OF CONCRETE PARAPET RAIL  
Scale: 1"=1'-0"

GENERAL NOTES

CONCRETE IN THE PARAPET RAIL SHALL BE CLASS S402 WITH A MINIMUM 28 DAY COMPRESSIVE STRENGTH  $f_c = 3500$  PSI.  
REINFORCING STEEL SHALL BE ASTM A616 OR A617, GRADE 60.  
NEW STRUCTURAL STEEL SHALL BE A36 AND SHALL BE MEASURED AND PAID FOR AS "STRUCTURAL STEEL IN BEAM SPANS A36."  
ALL ANCHOR BOLTS SHALL BE REPLACED; SEE DRAWING NO. 23215

DETAILS OF  
REMODELING SPANS 1 THRU 6 FOR  
CLARKE DALE INTERCHANGE  
MARION-LAKE DAVID OVERPASS ALTERATIONS  
CRITTENDEN COUNTY  
ROUTE I-55 SEC. 11  
ARKANSAS STATE HIGHWAY COMMISSION  
LITTLE ROCK, ARK.  
DRAWN BY: K.M.G. DATE: 17 SEPT. 79  
CHECKED BY: G.E.S. DATE: 10-21-79  
DESIGNED BY: DATE: SCALE: AS SHOWN  
BRIDGE NO. 3137R DRAWING NO. 23225